

LOW OF THE YEAR PAINT-O-RAMA

TRAIL
SATURDAY, APRIL 5
Sr. Horse - Class #407

7. JOG SERPENTINE AS SHOWN + INTO CHUTE

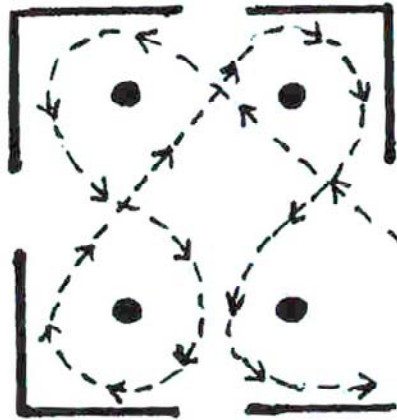

8 STOP - DISMOUNT & GROUND THE YOUR HORSE & WALK AROUND CONE & REMOUNT & WALK OUT OF CHUTE



6 WALK OVER BUDGES

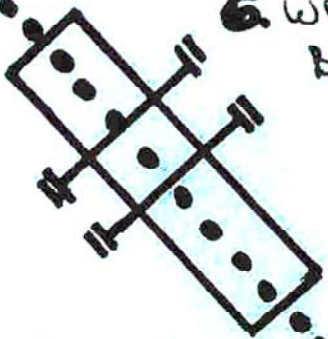

5. WALK THROUGH WATER BOX



3. WALK OVER POLES & INTO BOX

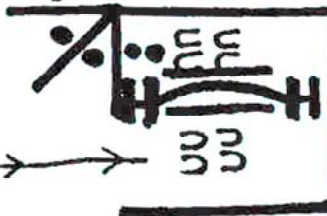

2 LEFT HAND ROPE GATE

1. RIGHT LEAD LOPE OVER POLES & SIMPLE CHANGE & LEFT LEAD LOPE OVER POLES TO GATE

START

4. 360° RIGHT & WALK OUT

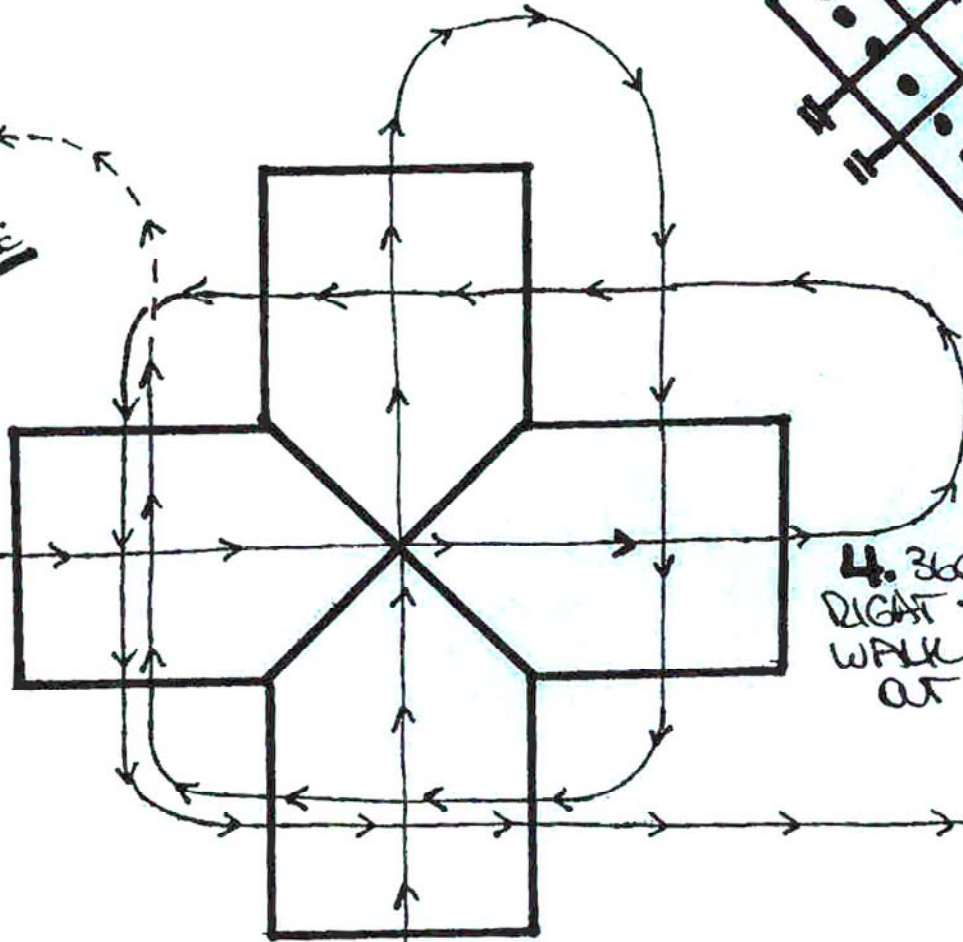

COURSE BY
DON LEHMAN

HOW OF THE YEAR PAINT-O-RAMA

TRAIL
SATURDAY, APRIL 5
Sr. Horse - Class #407

7. JOG SERPENTINE AS SHOWN + INTO CHUTE

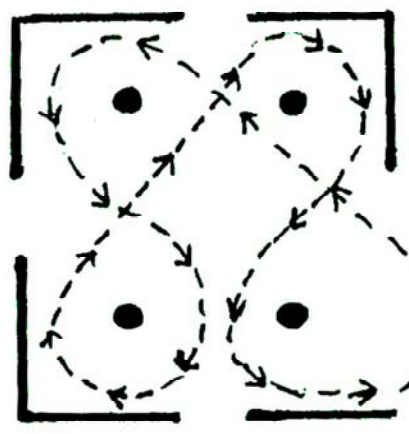

8 STOP - DISMOUNT & GRAB THE YOUR HORSE & WALK AROUND CONE & REMOUNT & WALK OUT OF CHUTE

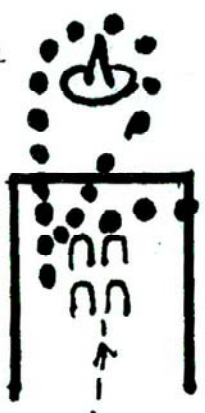

6 WALK OVER BRIDGES

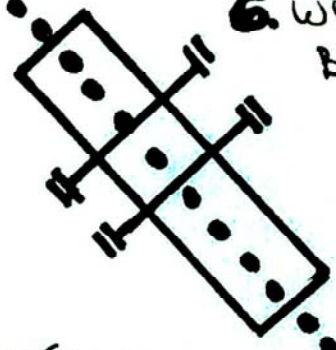

5. WALK THROUGH WATER BOX



3 WALK OVER POLES & INTO BOX



4. 360° RIGHT & WALK AT

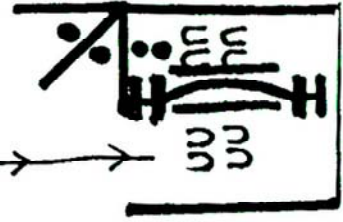
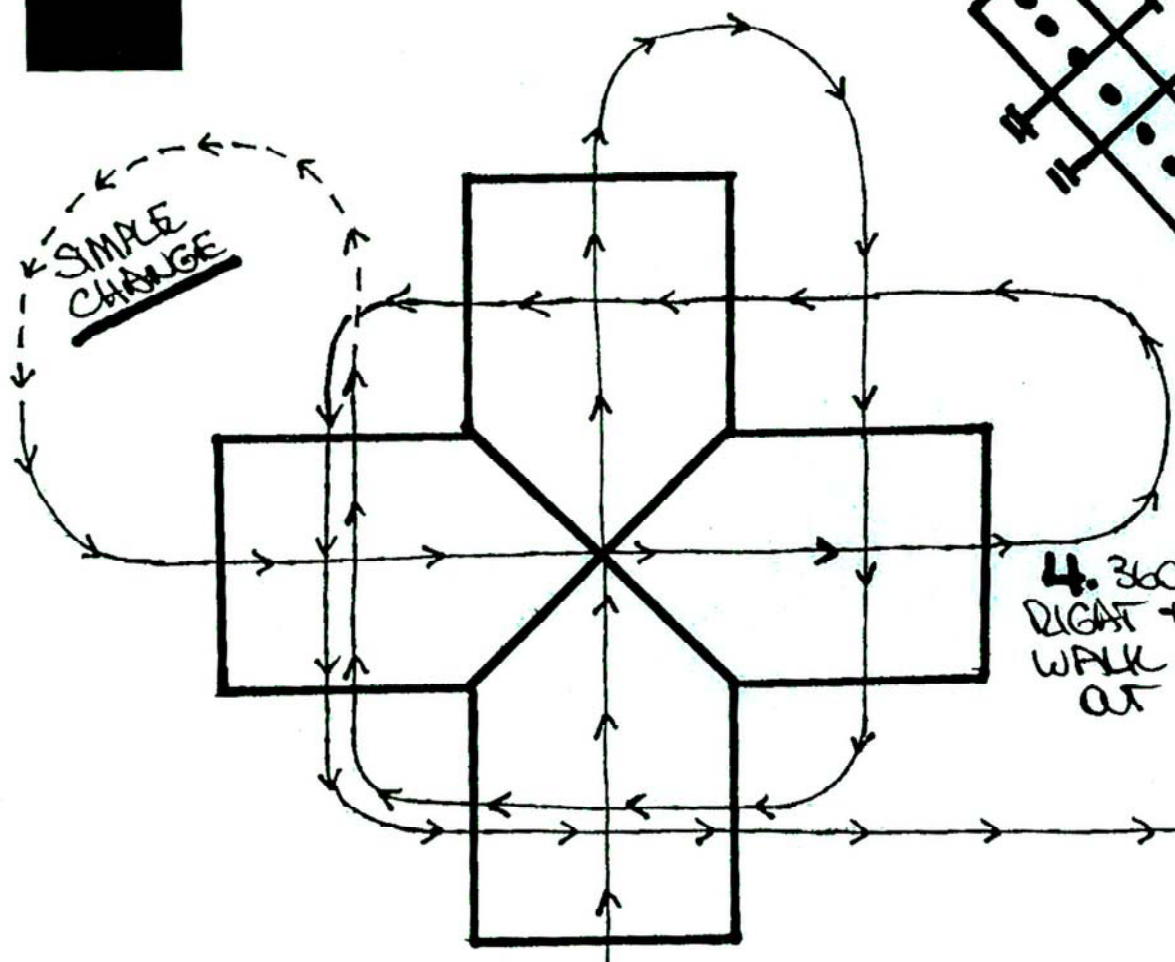

2 LEFT HAND ROPE GATE

1. RIGHT LEAD LOPE OVER POLES & SIMPLE CHANGE & LEFT LEAD LOPE OVER POLES TO GATE

START

COURSE BY
DON LEHMAN

Walk-Trot Trail

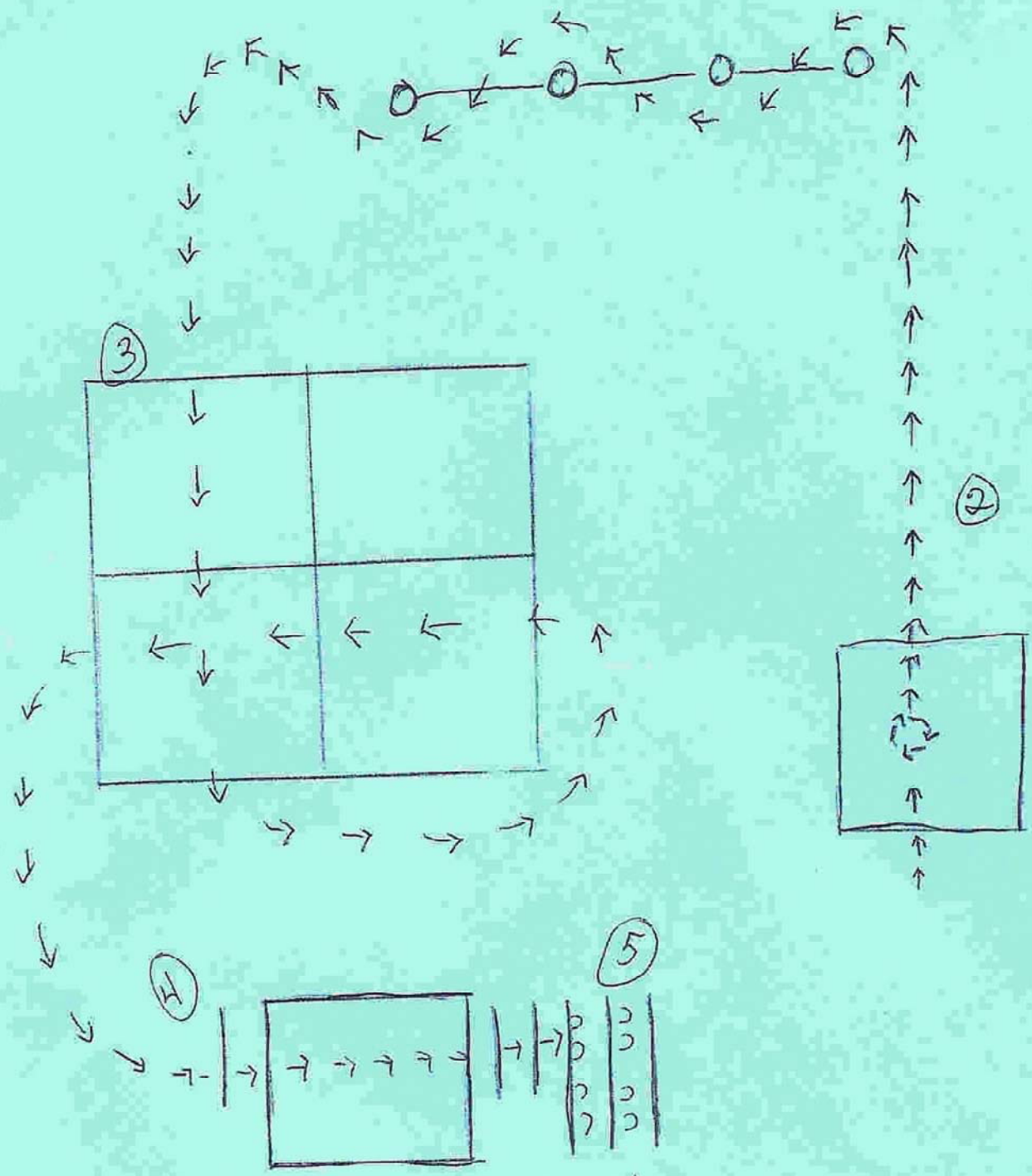

- ① Walk into box
Do 360 to Rt - Walk out
- ② Jog Serpentine
- ③ Jog Thru Boxes
- ④ Walk over poles & over bridge
- ⑤ Sidepass rt & exit

14-18
 Amateur
 Sr. Horse

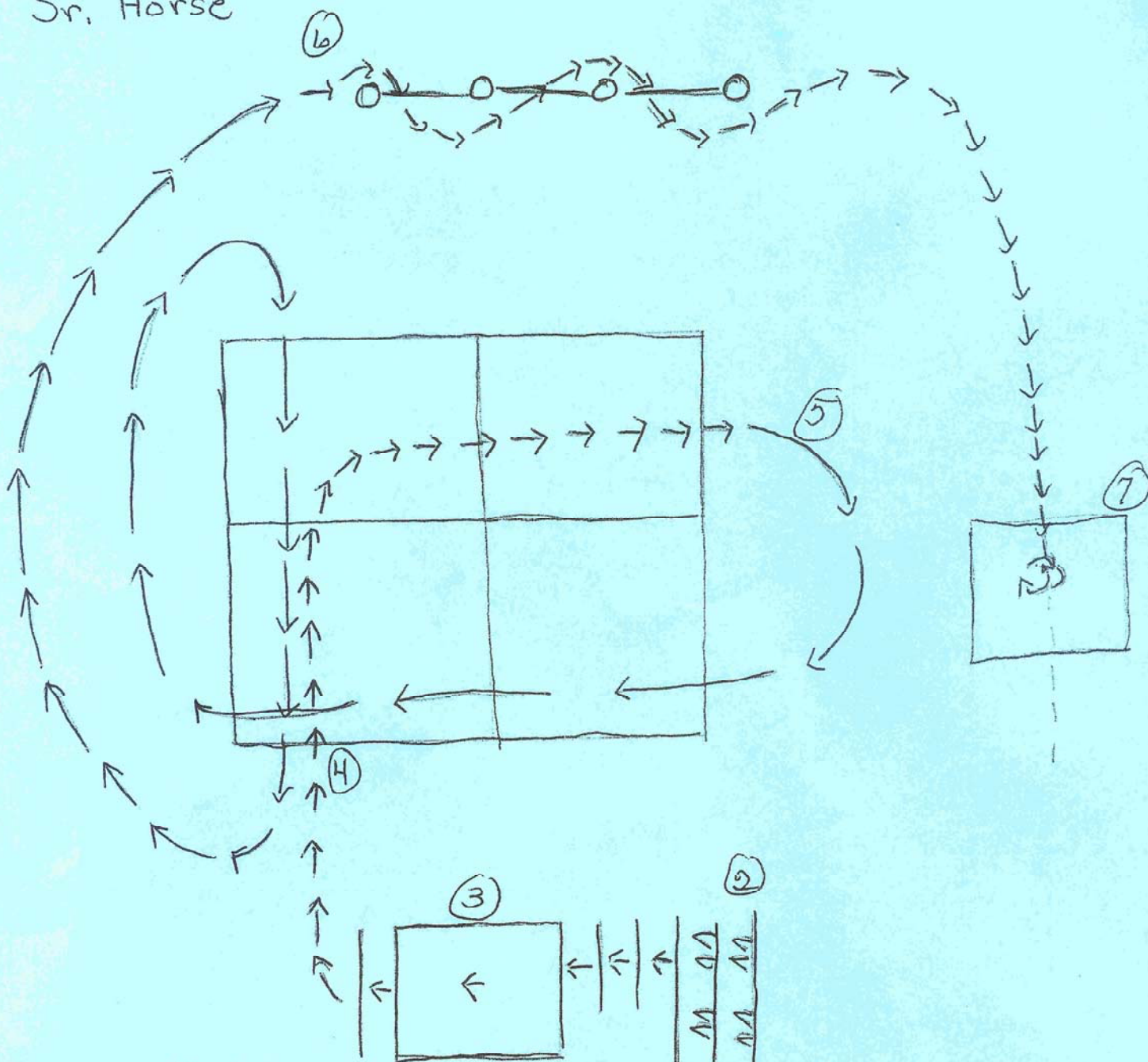

- ① Gate LF Push
- ② Sidepass Rt
- ③ Walk over poles + bridge
- ④ Jog thru boxes
- ⑤ Lope R/L Thru boxes
- ⑥ Jog Serpentine
- ⑦ Jog into bo - 360 to Rt - walk out

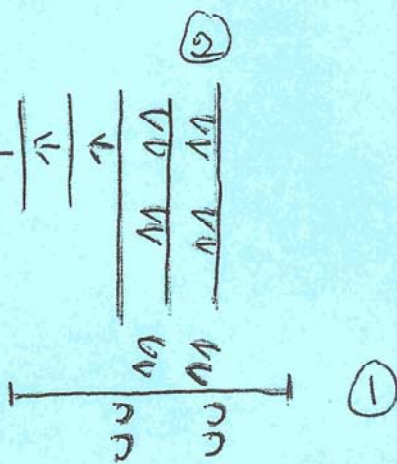

TRAIL
 THURSDAY, APRIL 3
 14 To 18 - Class #205Y
 Amateur - Class #206A
 Sr. Horse - Class #207

13 & under
 Jr. Horse
 Nov. Amat

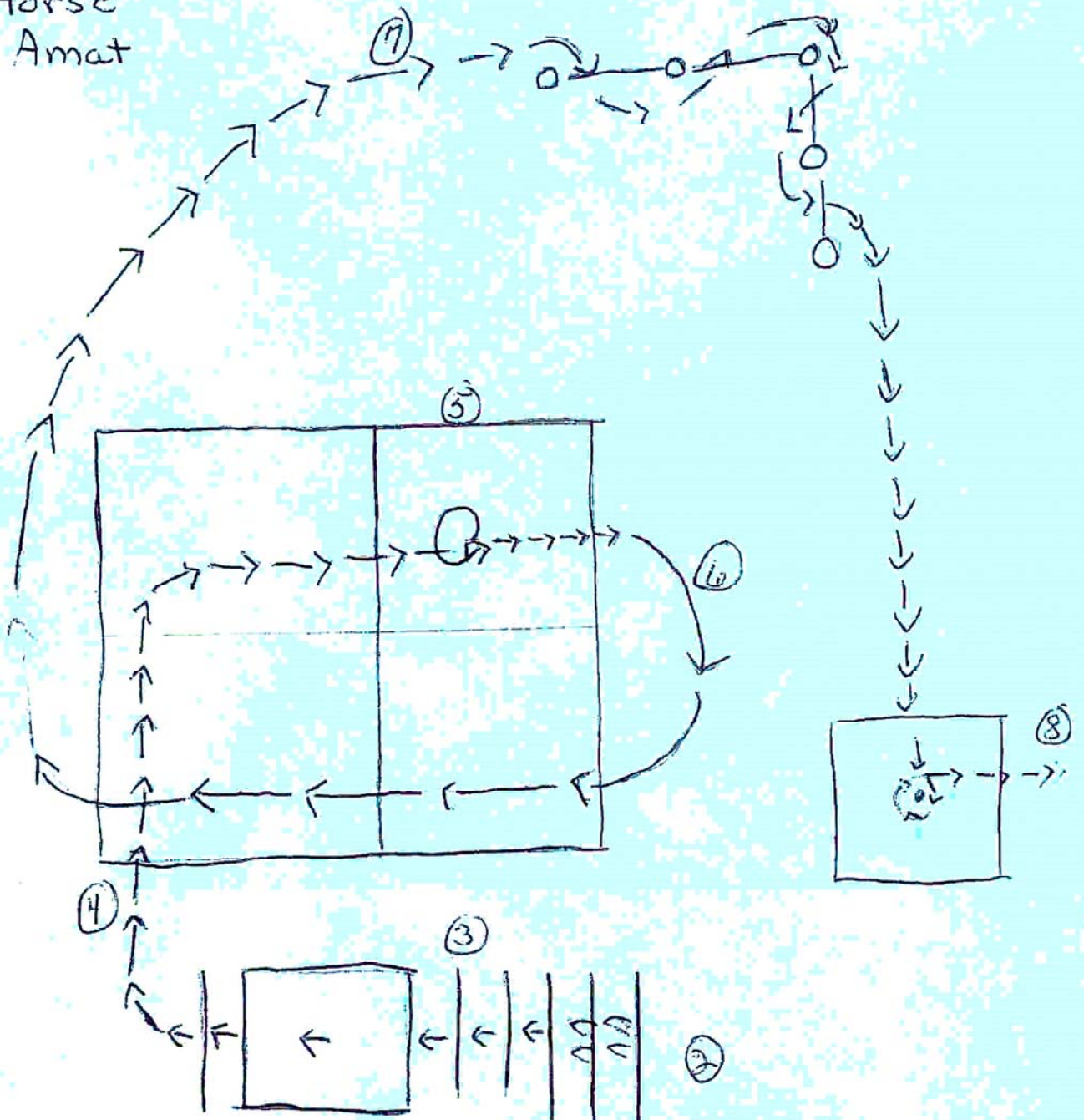

- ① Gate - left push
- ② Sidepass rt.
- ③ Walk over poles & bridge
- ④ Jog Thru boxes - stop in 3rd box
- ⑤ Stop - 360 left - walk out
- ⑥ Lope rt lead thru boxes
- ⑦ Jog serpentine
- ⑧ Jog into box & around zone & out

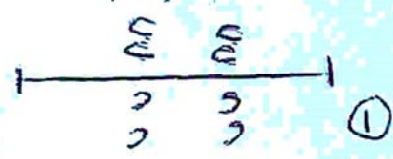

TRAIL
 THURSDAY, APRIL 3
 13 & Under - Class #202Y
 Jr. Horse - Class #203
 Novice Amateur - Class #204A